

Weld on Caps

Schedule 10, 316 Stainless Steel

Inches / Pounds

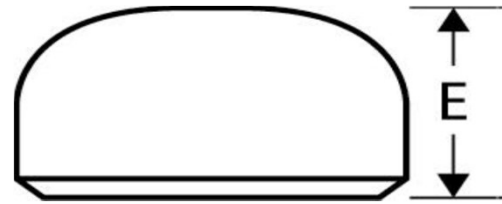

Part #	Nominal Pipe Size	Outside Diameter	Inside Diameter	Wall Thickness	Length (E)	Pipe Schedule	Approximate Weight (in Lbs.)
KC.5S	1/2	0.84	0.674	0.083	1.00	10	0.07
KC.75S	3/4	1.05	0.884	0.083	1.00	10	0.1
KC1S	1	1.32	1.102	0.109	1.50	10	0.1
KC1.25S	1 1/4	1.66	1.442	0.109	1.50	10	0.2
KC1.5S	1 1/2	1.90	1.682	0.109	1.50	10	0.2
KC2S	2	2.38	2.162	0.109	1.50	10	0.4
KC2.5S	2 1/2	2.88	2.640	0.120	1.50	10	0.5
KC3S	3	3.50	3.260	0.120	2.00	10	0.8
KC4S	4	4.50	4.260	0.120	2.50	10	1.2
KC5S	5	5.56	5.292	0.134	3.00	10	2.4
KC6S	6	6.62	6.352	0.134	3.50	10	3.1
KC8S	8	8.62	8.324	0.148	4.00	10	5.9

** Dimensions conform to ASME B16.9 & MSS SP-43*

** Material conforms to ASTM A430 Grade 316/316L*